



MICRO

PERFECT FOR MOBILE APPLICATIONS.

The low-voltage power supply system can be retrofitted quickly and easily and is compatible with 12 V and 24 V systems. Installation using adhesive or magnetic tape is child's play; the current collectors and feeders are secured in place with a simple twist at any point along the profile.

SYSTEM BENEFITS

- For 12 V / 24 V
- Mounting with adhesive tape or magnetic tape
- Easy installation of the feeder and current collector at any location
- For luminaires in protection class III
- D8 Mini plug-in system, suitable for all ELEKTRA low-voltage lights



Surface-mounted power conductor profile

- Magnetic strip/adhesive mounting
- End cap included

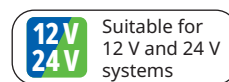

Suitable for
12 V and 24 V
systems

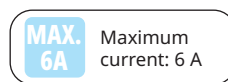

MAX. 6A
Maximum
current: 6 A



PRODUCT FEATURES

Operating voltage	12V / 24 V
Current	Max. 6 A
Material	Plastic Copper conductor
Power	Max. 72 W per track (bei 12 V) Max. 144 W per track (bei 24 V)
Length	See chart
Connection cable	95 mm / 1000 mm
Connector system	D8 Mini
Mounting	Adhesive mounting Magnetic mounting
Protection	IP 20
Protection class	III

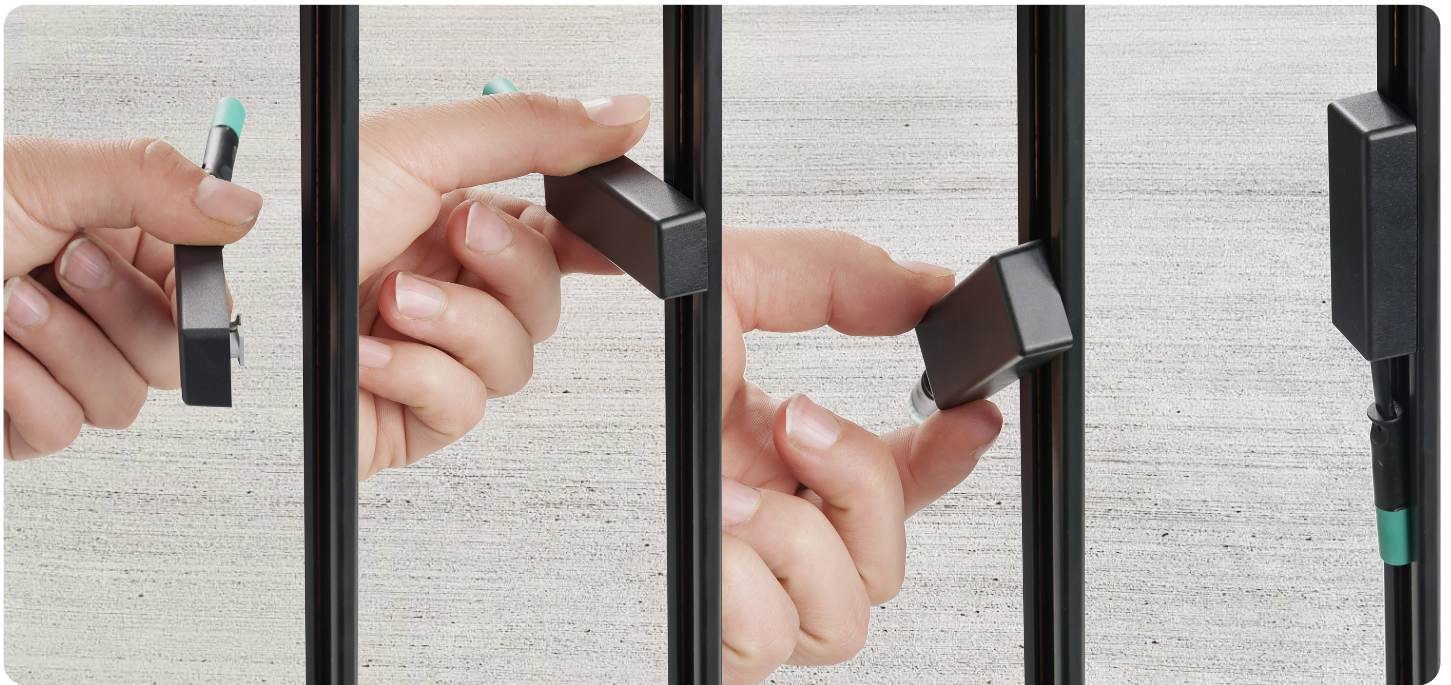

SYSTEM COMPONENTS



2
End cap
• Plastic



3
Feeder with mini plug
• 1000 mm cable with mini plug



4
Current collector with mini-socket
• 95 mm cable with mini-plug

CONDUCTOR PROFILES

Art. No.	Description	Length (mm)	Weight (g)
① 540 167 90	Profile, magnetic mounting	1000	190
540 167 89	Profile, magnetic mounting	1300	247
540 167 88	Profile, magnetic mounting	1600	300
540 167 87	Profile, magnetic mounting	1800	342
540 176 14	Profile, magnetic mounting	2000	390
540 167 81	Profiles, adhesive mounting	1200	168
540 167 82	Profiles, adhesive mounting	1300	182
540 176 15	Profiles, adhesive mounting	2000	220
② 540 167 86	End cap, single		1
③ 540 167 38	Feeder		40
④ 540 172 89	Current collector	95	13
on request	Current collector	60	10